

### Hydraulic Control Valves Y-Pattern

Size: 1½"; DN40

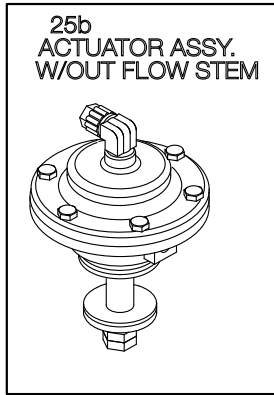

□ 25 ACTUATOR ASSY. FOR METAL BODY (25a FOR PLASTIC BODY)

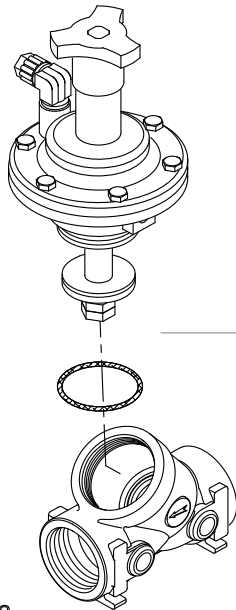

1a PLASTIC BODY

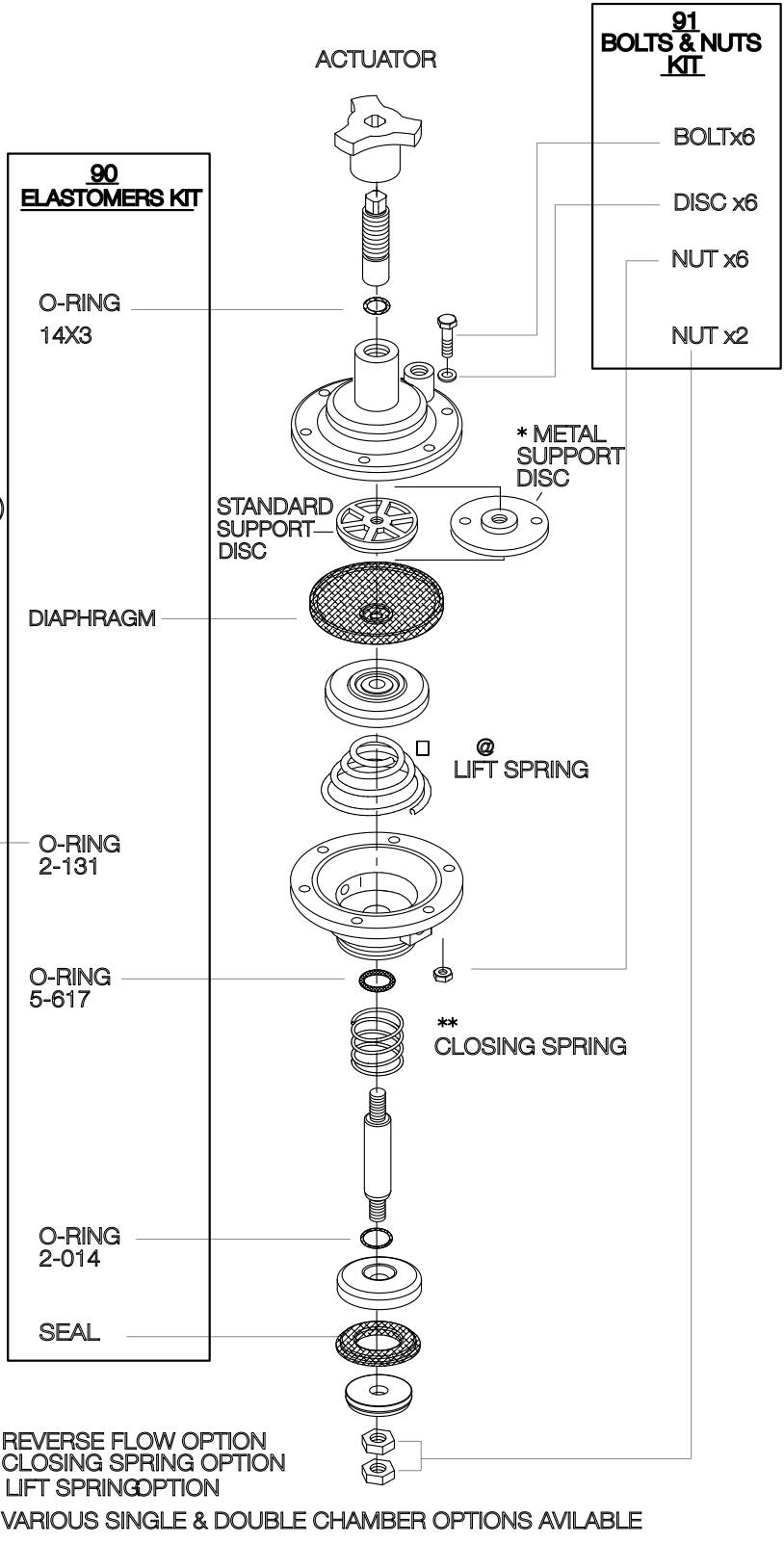
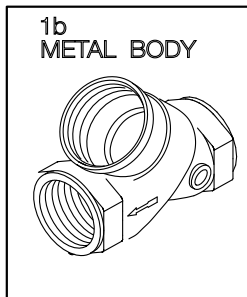

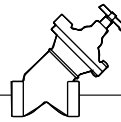

### Hydraulic Control Valves Y & A-Pattern

Size: 2"; DN50

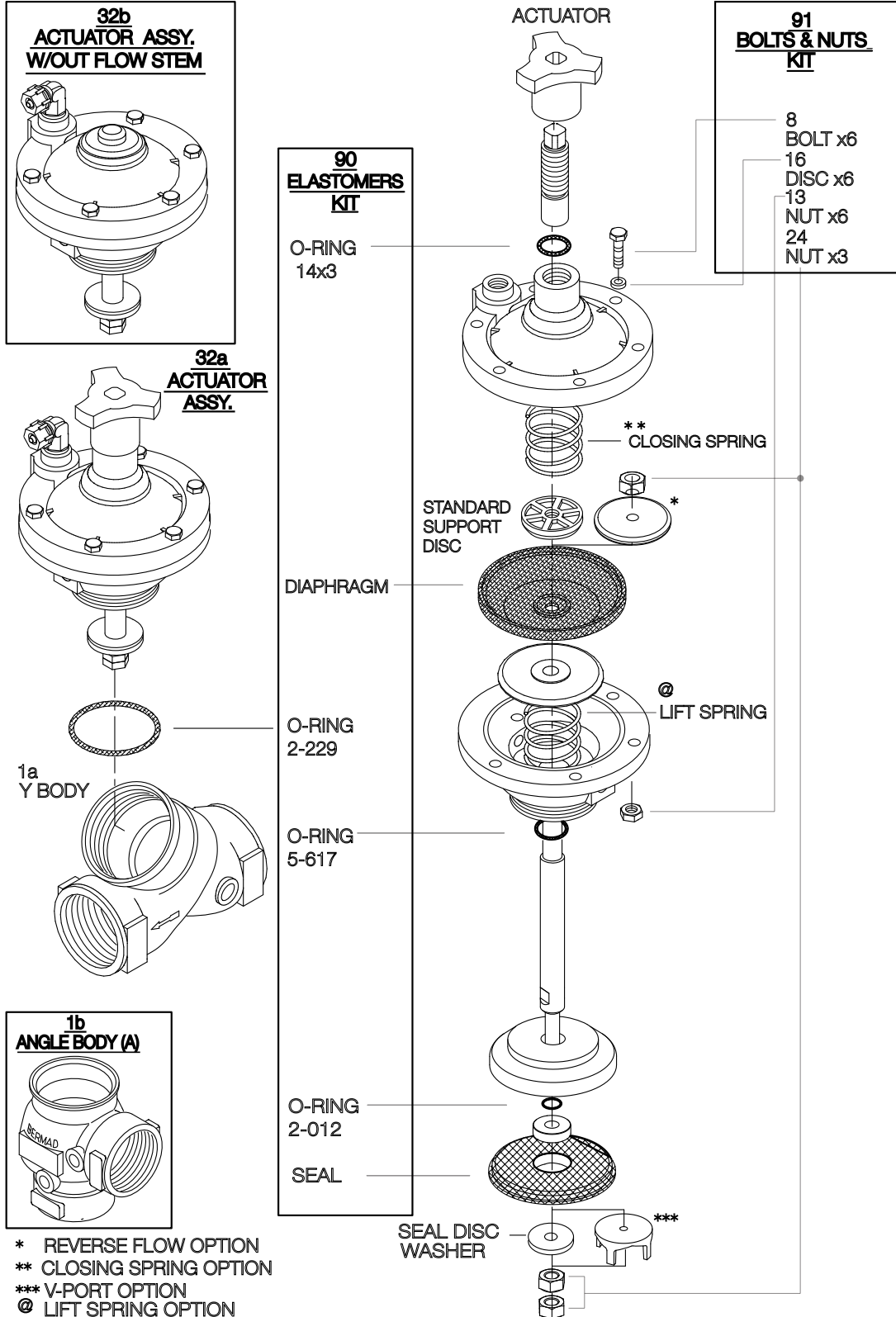

- \* REVERSE FLOW OPTION
- \*\* CLOSING SPRING OPTION
- \*\*\* V-PORT OPTION
- @ LIFT SPRING OPTION

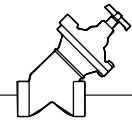

### Hydraulic Control Valves Y-Pattern

Size: 3"; DN80

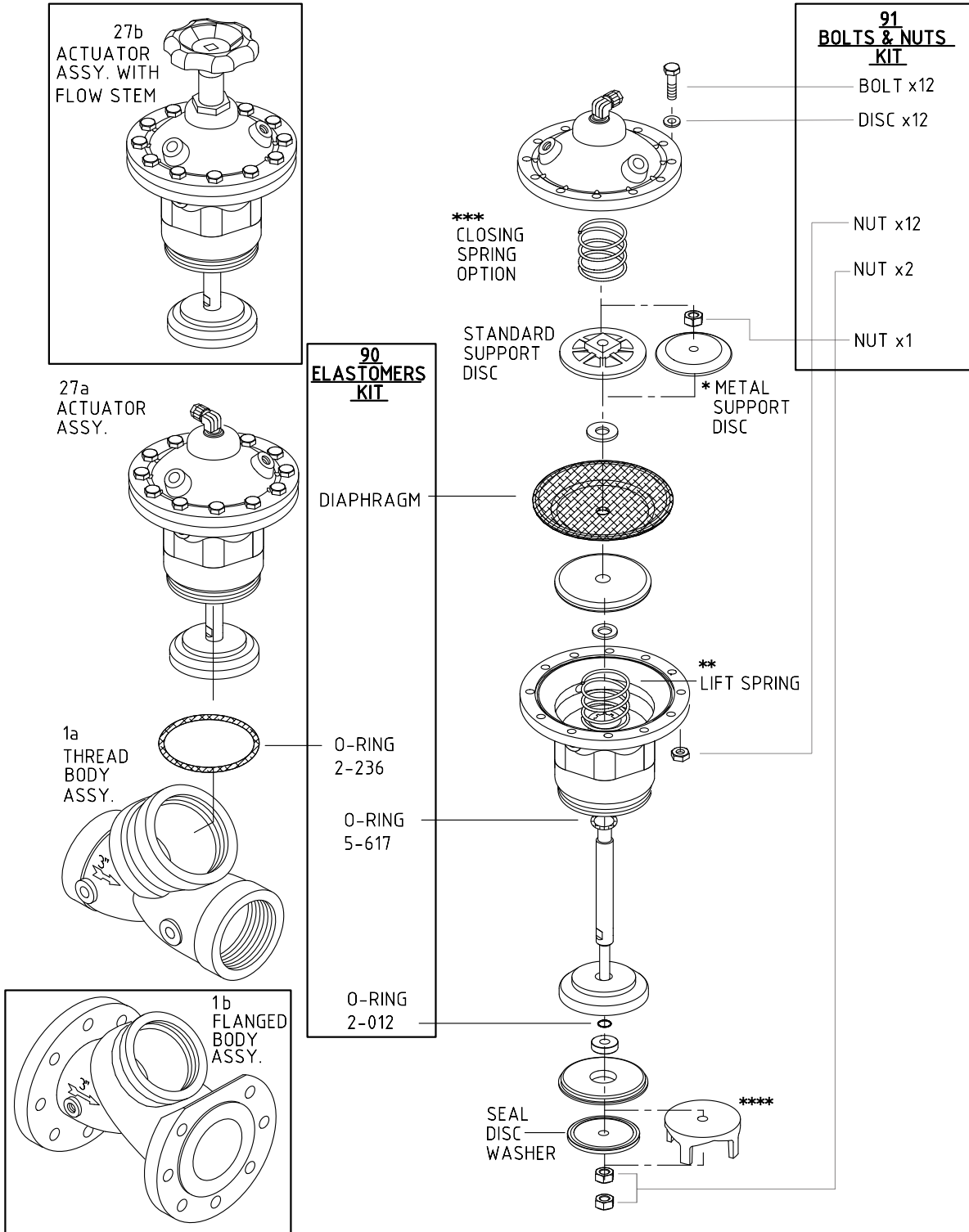

- \* REVERSE FLOW OPTION
- \*\* LIFT SPRING OPTION
- \*\*\* CLOSING SPRING OPTION
- \*\*\*\* V-PORT OPTION