

Y, A, T, & D-Pattern Hydraulic Control Valves

Sizes: 2L-3"; DN50L-80

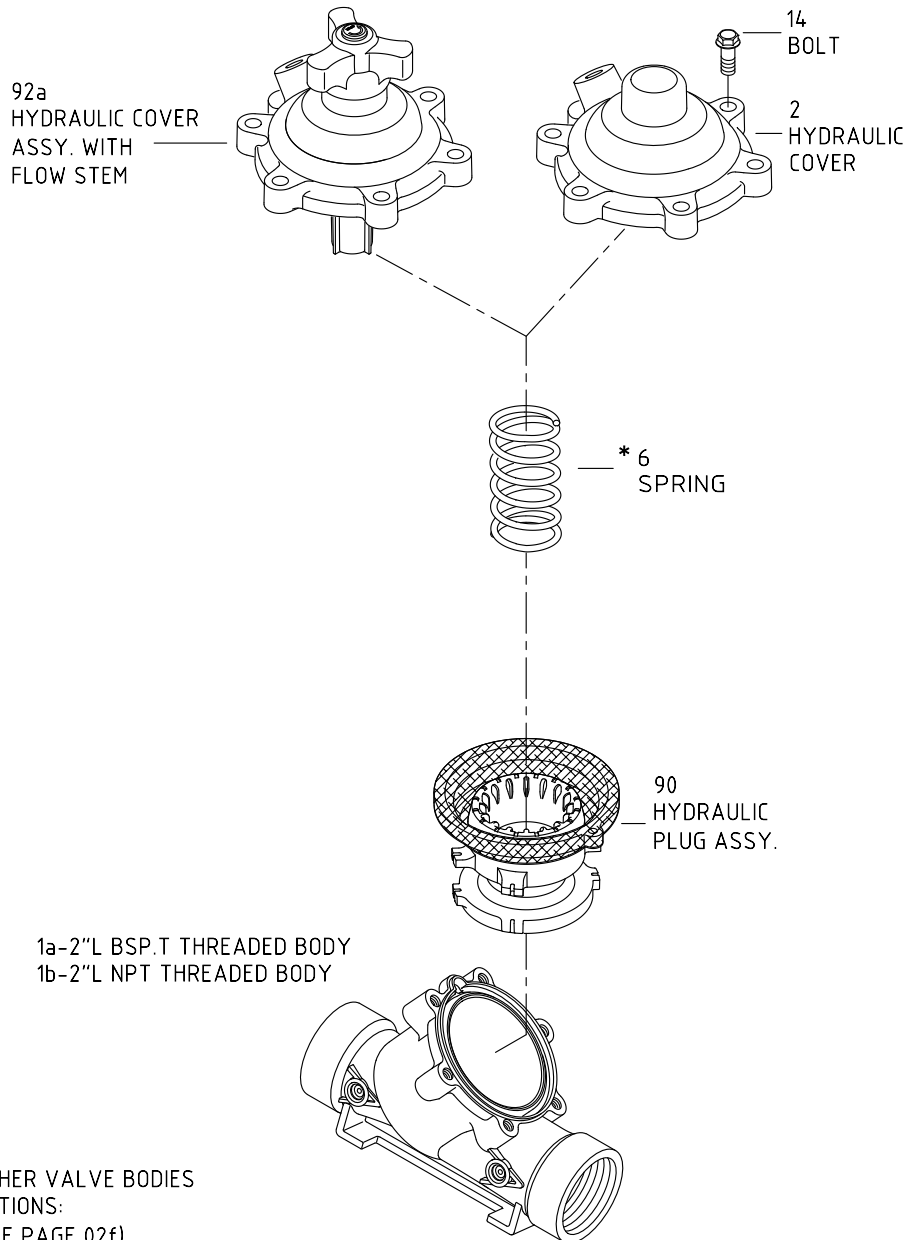

OTHER VALVE BODIES
OPTIONS:
(SEE PAGE 02f)
VARIOUS END CONNECTIONS ADAPTERS
(SEE PAGE 02g)

* DIFFERENT SPRINGS