

## Diaphragm Actuated Basic Control Valves

Sizes: 4"-20"

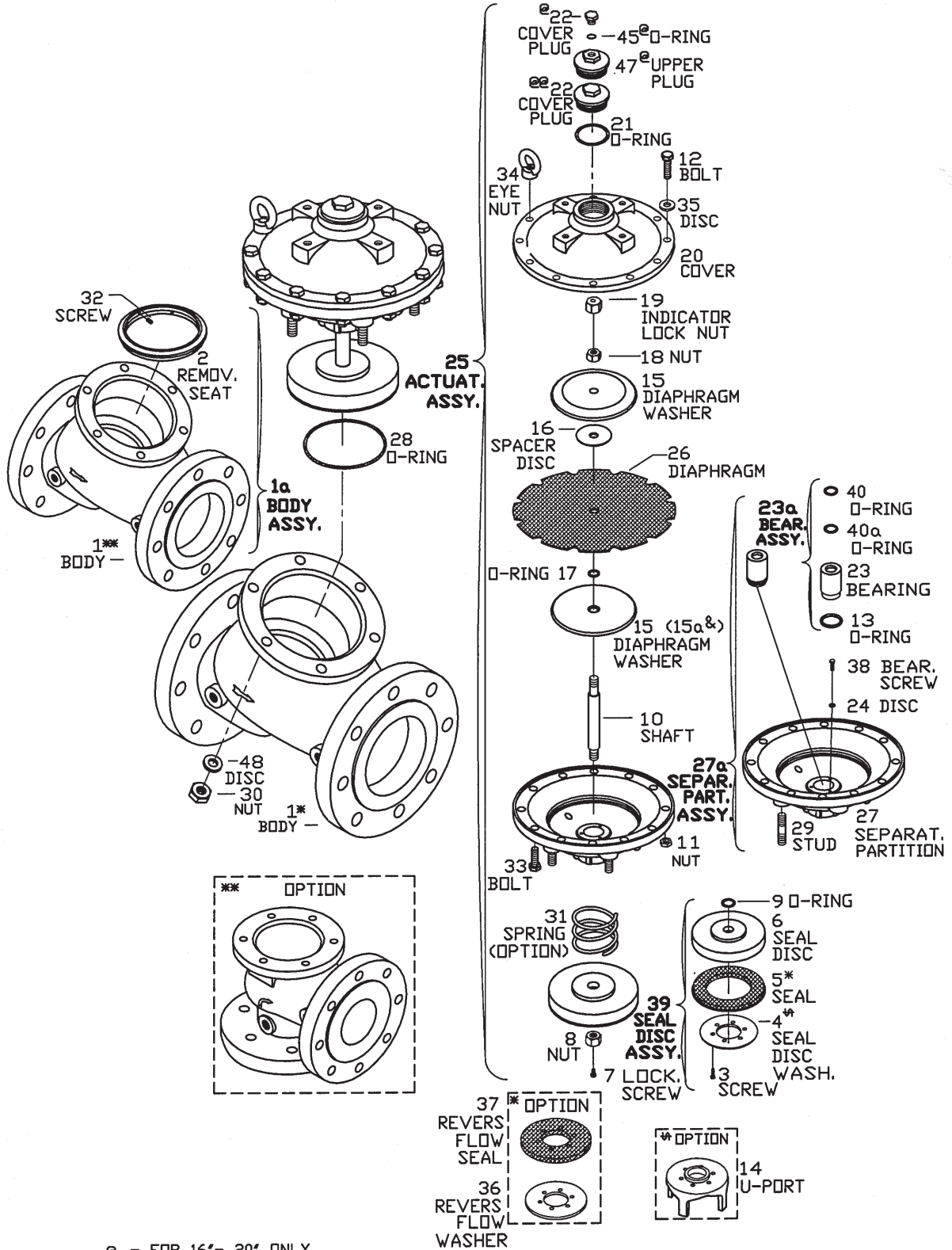

⊕ - FOR 16"- 20" ONLY  
 ⊕⊕ - FOR 4"- 14" ONLY  
 & - FOR HIGH PRESSURE ONLY

**WW-700 Series Elastomers**

Created 1.8.2009

Updated 5.8.09

Page Number	700	Part No.		Part No.		Part No.		Part No.		Part No.		Part No.		# KIT Item No.
		O-ring code # Item No. (Qty - 1)	O-ring code # Item No. (Qty - 2)	O-ring code # Item No. (Qty - 1)	O-ring code # Item No. (Qty - 2)	O-ring code # Item No. (Qty - 1)	O-ring code # Item No. (Qty - 2)	O-ring code # Item No. (Qty - 1)	O-ring code # Item No. (Qty - 2)	O-ring code # Item No. (Qty - 1)	O-ring code # Item No. (Qty - 2)	Material # Item No. (Qty - 1)	Material # Item No. (Qty - 1)	
38	1.5"-2.5" DN40-DN65	2-232	8	29	13	21	26	(p.41 p.43)	5	2520-00000				
		0535171232	0527172130	0517172007	0517172007	0526172310	25200B0510	25200B2503						
39	3" DN80	2-237	9	13	35	21	26	(p.41 p.43)	5	2530-00000				
		0535171237	0527172130	0517172007	0517172007	0526172310	25300B0312	25300B2506						
40	4" DN100	2-246	40	13	17	21	26	(p.41 p.43)	5	2540-00000				
		0535171246	0527172130	0526172466	0517172007	0526172310	22400B0026	25400B2322						
40	6" DN150	2-364	9	13	17	21	26	(p.41 p.43)	5	2560-00000				
		0535171364	0535172061	0526172171	0527172130	0535172365	22600B0026	25600B2305						
40	8" DN200	2-372	9	13	17	21	26	(p.41 p.43)	5	2580-00000				
		0535171372	053517216	0526172566	0526172111	0535172365	22801B0026	25800B2305						
40	10" DN250	2-379	40	13	17	21	26	(p.41 p.43)	5	2510-00000				
		0535171379	0535172034	0526172160	0526172166	0535172365	22011B0026	25010B2305						
40	12" DN300	2-456	9	13	17	21	26	(p.41 p.43)	5	2512-00000				
		0569171456	0553172027	0535172365	0526172466	0535172365	25120B0326	25120B2305						
40	16"-20" DN400-500	2-466	2-230	2-340	2-223	2-119 + 2-236	NBR	2-011	NBR	2516-00000				
		0569171466	0535171230	0553171333	0535171223	0535172125 (21) & 0526172310 (45)	25160B0326	25160B2305						

\* Please note that some items may be used for various sizes and positions.  
 \* Data correct at "Updated" date only, please consult factory for updated data.